

# Patio Series Fireplaces

## Steps for Construction:

Installation of the Stone Age Contractor Series fireplace is very simple. Project and site preparation should include pouring a reinforced concrete footing for the unit. Depth of the footing and specific reinforcement requirements, such as piers, should be determined based on size of the unit, type of finish material to be applied, local soil stability, climate and building customs. Use the chart at right as a minimum guideline.

- 1) Determine the desired height of the firebox floor. Use concrete block to build the base to place the firebox at the desired height above the finished grade or the footing.
- 2) Once the base is level and square, set the baseplate #2. Level it front to back and side to side. Next, if using firebrick, install pieces #3 through #4 in order shown in the images. If using Stone Age Refractory Panels, install them before pieces #3 through #4. Keep each piece level and plumb as you go up.
- 3) It is the easiest to install the firebrick inside the firebox AFTER piece #4 and before piece #8. Line the floor, then the back and then sidewalls. Apply 1/4" thick layer cement to the back of brick and 1/4" mortar joint around the brick. NOTE: add extra cement to mixture when applying brick and add water to thin down mixture. You want your cement richer and wetter when applying firebrick. If using Stone Age Multi-Purpose Ready-Mix, it is not necessary to add water to the mix.
- 4) Continue installation of pieces #8 thru #9A. (Note: 48" units require #11 throat adapter, which mounts atop #8). You are now ready for the installation of a custom hearth if desired, and to begin exterior finishing.
- 5) **IMPORTANT NOTE:** Unit should not be fired for 28 days after completion, to allow full curing of mortar and to release moisture within the fireplace components. Break in or cure the fireplace by building 3 small fires before building a larger fire.

Minimum Requirements for Footing		24"	36"	48"
Thinner Finishes- Fabricated Stone, Stucco, Stain or Tile	A	4" - 6"	6" - 8"	8" - 10"
	B	Varies	By	Project
	C	40"	52"	64"
Thicker Finishes- Full Veneer Natural Stone or Brick	A	8" - 12"	12" - 18"	18" - 24"
	B	Varies	By	Project
	C	46"	58"	70"

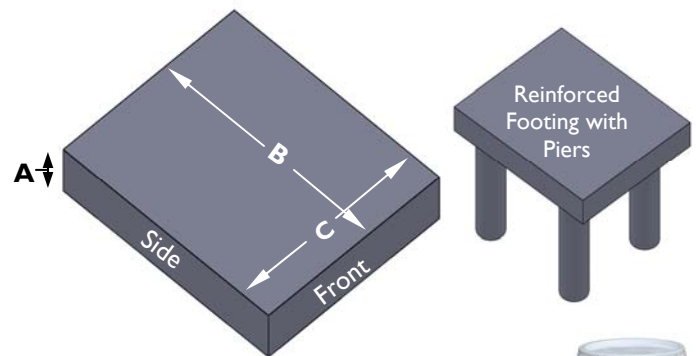

Stone Age recommends using our Multi-Purpose Ready-Mix for the assembly of all Stone Age products.

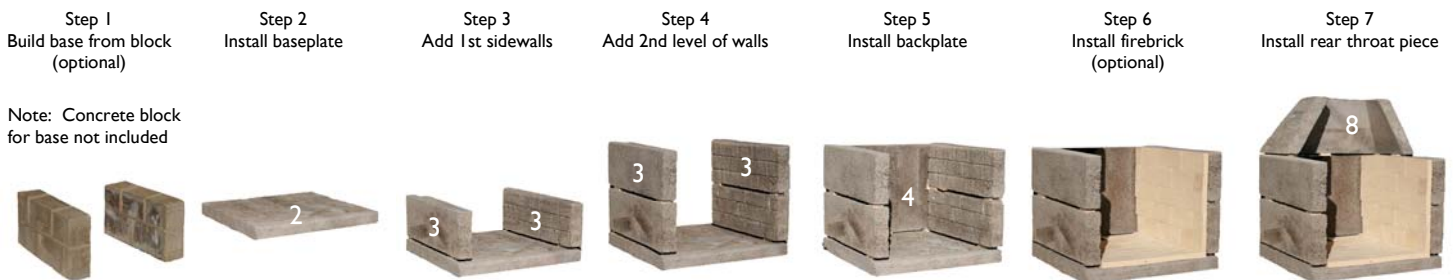

Note: Concrete block for base not included

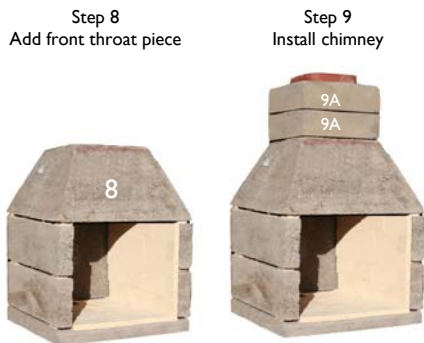

### Notes:

- Do not install within 8 feet of combustible materials.
- Firebrick or Refractory Panels are not required, but may be installed if desired.
- Fireplace may be installed on a raised base of concrete block.
- No more than 4 feet of additional chimney should be added to fireplace kit.
- Installation of a chimney cap is strongly recommended.

Once the kit is assembled, finish application may begin. Any masonry-compatible finish, such as stucco, tile, brick, man-made stone, pavers or natural stone, may be used with all Stone Age products, and may be applied directly to the outside of the units. Customization is very simple, as standard concrete block may be directly applied around any unit to create a different shape or profile, before application of the finish material.

## Construction Diagram

## Assembled Kit

## Recommended Optional Items

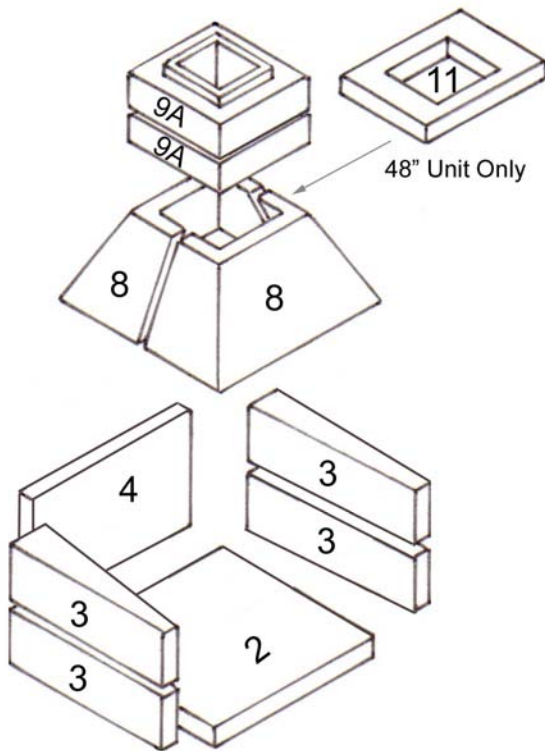

Multi-Purpose Ready-Mix



Firebrick



Refractory Panel Kit



Log Grate



Chimney Cap



Part # / Name	24" PS	36" PS	48" PS
#2 Baseplate	34" w x 33" d	46" w x 33" d	58" w x 33" d
#3 Sidewall	11" t x 33" d	11" t x 33" d	11" t x 33" d
#4 Backplate	22½" t x 28" w	22½" t x 40" w	22½" t x 52" w
#8 Throat	19" Sq at top x 16" t	23" Sq at top x 16" t	23" d x 30" w x 16" t
#9A Flue	19" Sq x 6" t	23" Sq x 6" t	23" Sq x 6" t
#11 Throat Adapter	N/A	N/A	23" d x 30" w x 4" t
<b>Outside Dimensions &amp; Specifications</b>			
Firebox Outside Depth	33" d	33" d	33" d
Firebox Opening Height	Straight: 23" t	Straight: 23" t	Straight: 23" t
Overall Height	54"	54"	58"
Overall Weight	1100 lbs	1500 lbs	1900 lbs
Finishing Specifications	49 Sq ft of surface, including 22 Ln ft of corners	71 Sq ft of surface, including 22 Ln ft of corners	94 Sq ft of surface, including 22 Ln ft of corners
<b>Abbreviations:</b> t = tall d = depth - from front to back sq = square w = width - from side to side			